

2 SECOND FLOOR PLAN-POWER
1/8" = 1'-0"

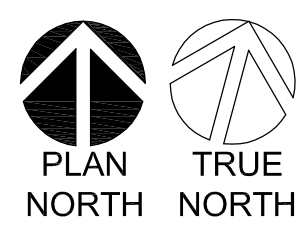
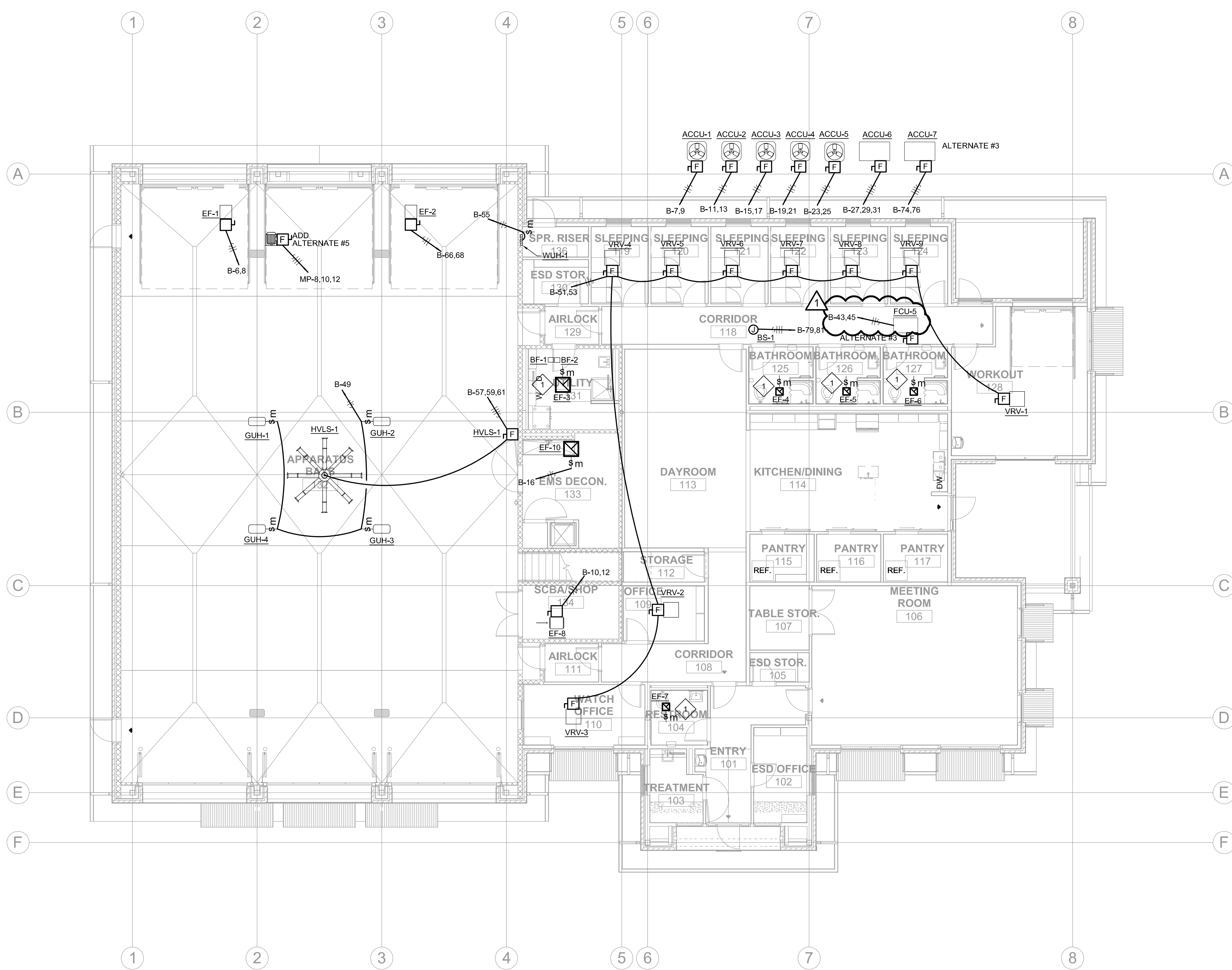

1 FIRST FLOOR PLAN-POWER
1/8" = 1'-0"

POWER KEYED NOTES:

- CONTROL THIS FAN WITH LIGHT FIXTURES IN THIS ROOM.
- PROVIDE 120V CONNECTION FOR GSSF CONNECTION. COORDINATE EXACT LOCATION AND REQUIREMENTS WITH PLUMBING CONTRACTOR PRIOR TO ROUGH-IN.

BROWN REYNOLDS WATFORD ARCHITECTS
2700 FAR BRIDGE FERRY SOUTH
SUITE 6000 HOUSTON, TEXAS 77045
979.604.1791
WWW.BRWARCH.COM

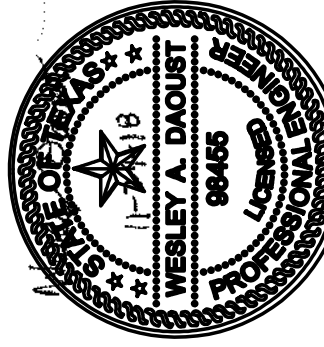

1555 WINDY BRANCH FAIR DR
HOUSTON, TX 77059
WWW.DVO.COM
REGISTRATION NO. FE384

COPYRIGHT © 2018
BROWN REYNOLDS WATFORD ARCHITECTS, INC.
DATE 11/16/2018
DRAWN BY KJM
CHECKED BY JF
BRW PROJECT NUMBER 217079-00

CITY OF GEORGETOWN
GEORGETOWN FIRE STATION No. 6
6700 R. I.M. 2338
GEORGETOWN, TX, 78626

NO.	REVISION	DATE
1	ISSUE FOR PERMIT	11/16/18
	ADDENDUM 1	11/29/18

E1.4

FLOOR PLAN
MECHANICAL POWER

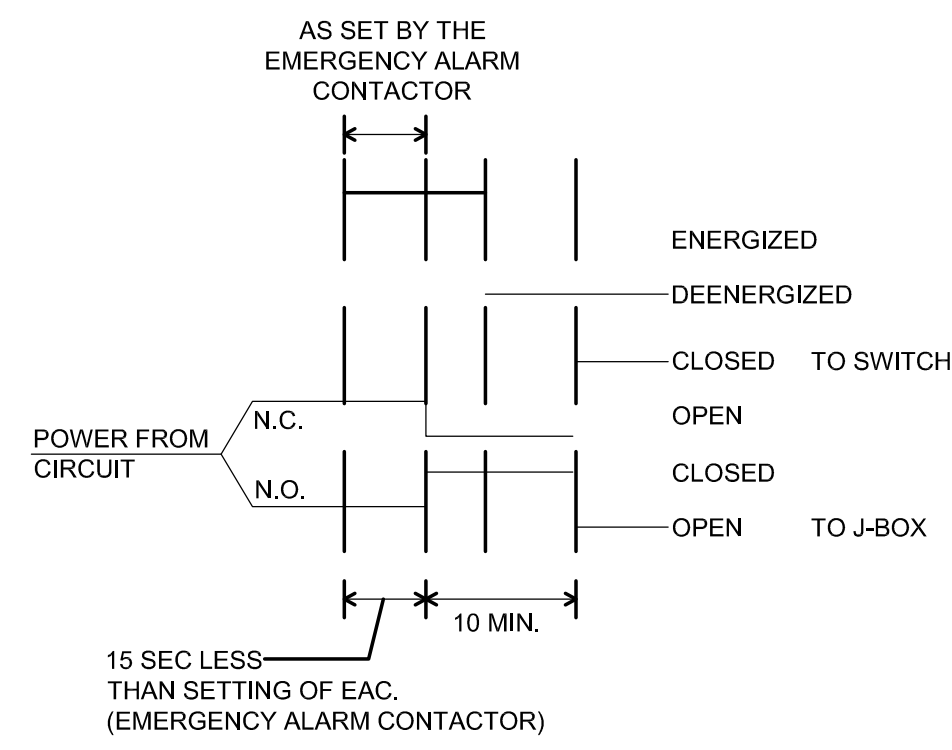

02 FAN TIMER FOR EXHAUST FANS EF-1 & EF-2
NOT TO SCALE

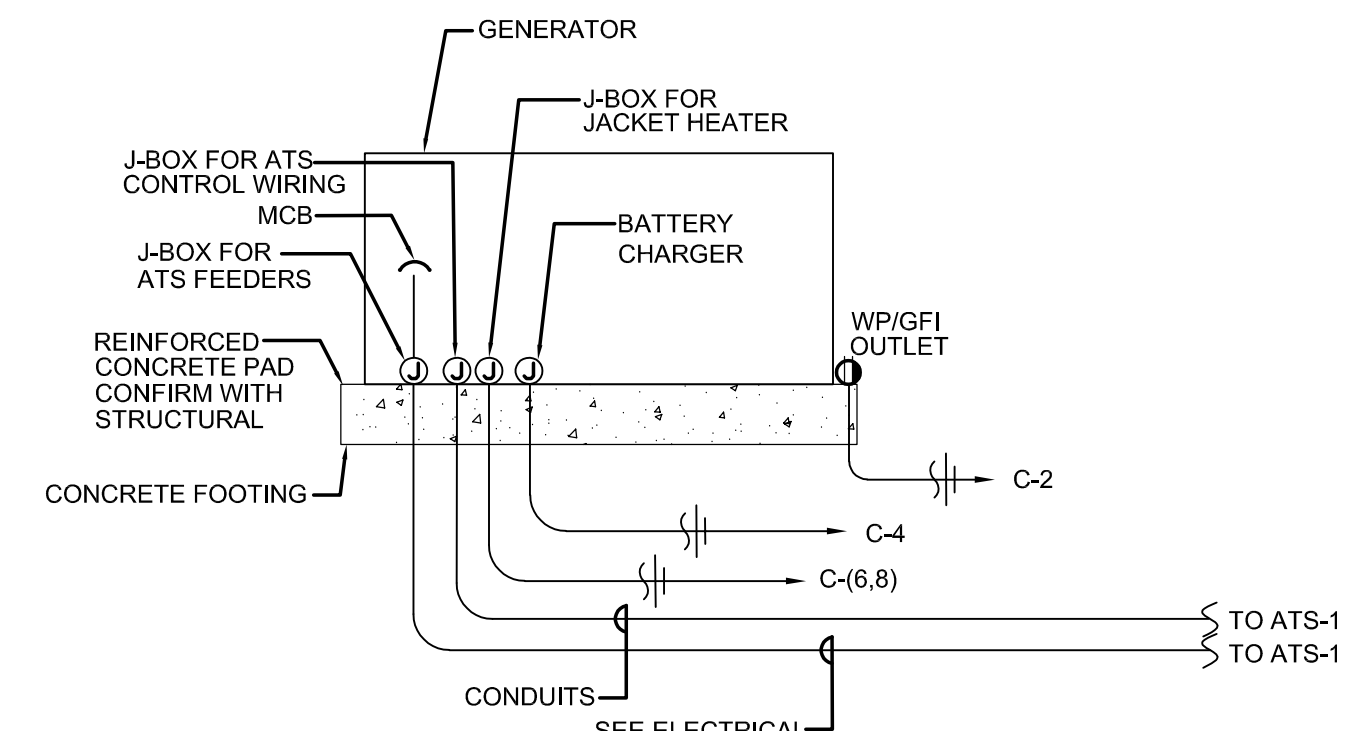

03 GENERATOR DETAIL

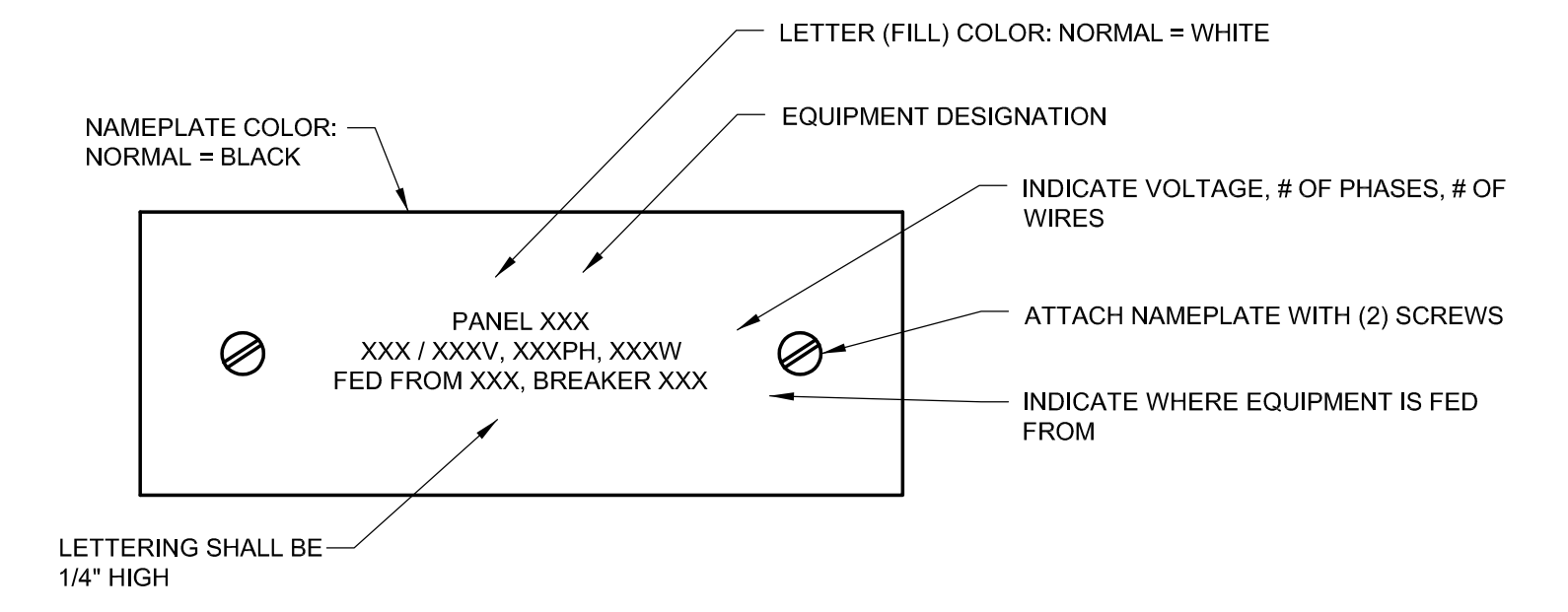

04 PANELBOARD NAMEPLATE DETAIL
NOT TO SCALE

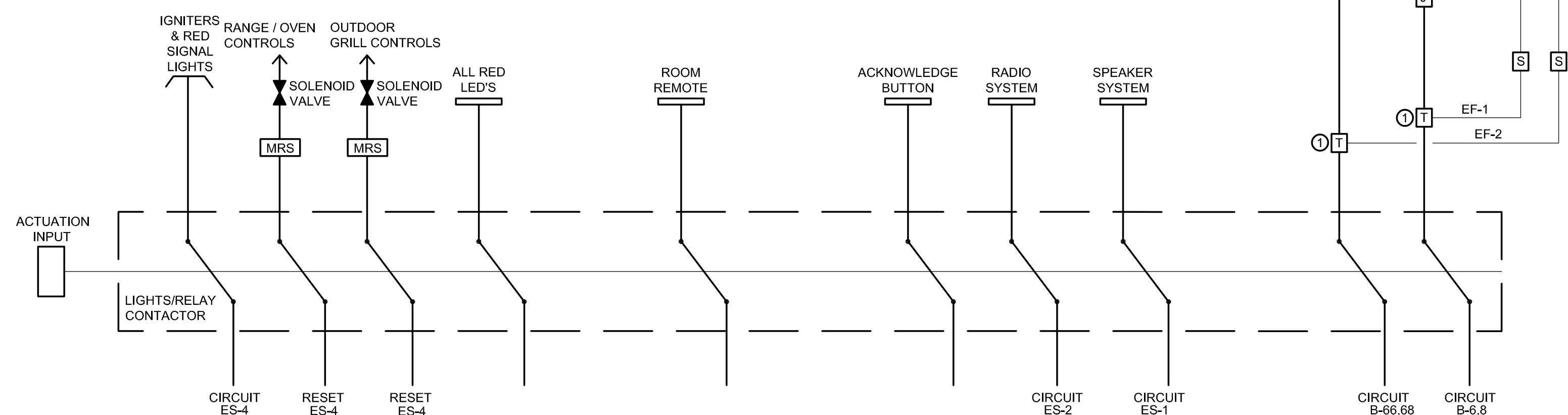

- KEYED NOTES:**
- 1. ON-DELAY / OFF-DELAY FAN TIMER. SEE FAN TIMER DETAIL FOR SEQUENCE OF OPERATION.
 - 2. SEE KEYED NOTE 10 SHEET E1.1 FOR SEQUENCE OF OPERATION ON GAS SOLENOID VALVE.
 - 3. CONTRACTOR TO PROVIDE AND INSTALL CONTACTOR, FAN TIMER, RELAY CONTROLS TO ENSURE A FULLY FUNCTIONAL SYSTEM.
 - 4. SEE SPEAKER ONE LINE AND FAN TIMER DETAIL THIS SHEET FOR APPARATUS BAY EXHAUST FAN SEQUENCE OF OPERATION AND CONTROLS.
 - 5. COORDINATE WITH MECHANICAL, PLUMBING, AND ALERTING SYSTEM SUB CONTRACTORS.
- NOTES:**
- 1. WALL SWITCHES
 - 2. JUNCTION BOX
 - 3. FAN TIMER ON DELAY / OFF DELAY

05 EMERGENCY ALARM SCHEMATIC FOR ALERTING SYSTEM
NOT TO SCALE

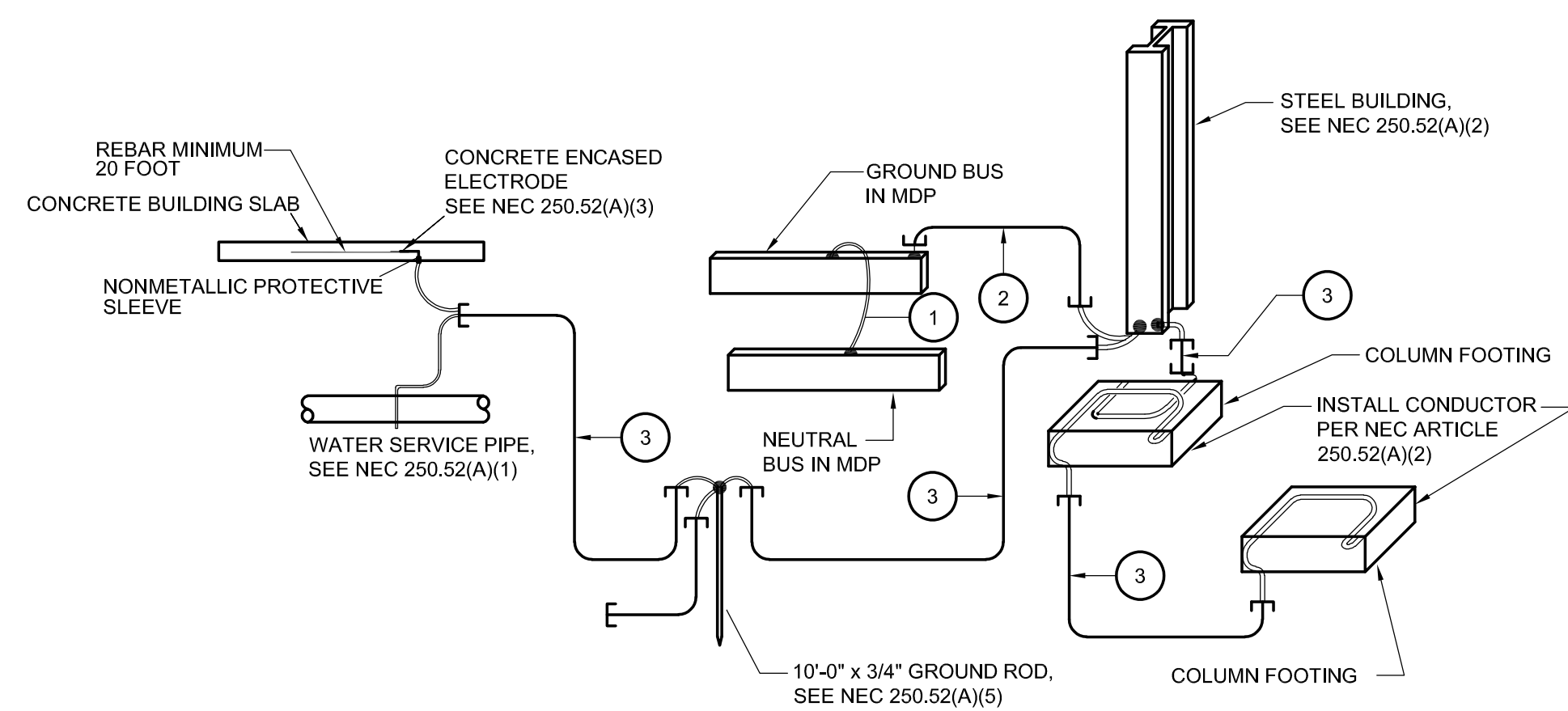

- KEYED NOTES:**
- 1. BARE COPPER MAIN BONDING JUMPER PER NEC 250.28.
 - 2. BARE COPPER GROUNDING ELECTRODE CONDUCTOR PER NEC 250.66.
 - 3. BARE COPPER GROUNDING ELECTRODE BONDING JUMPER PER NEC 250.53.
- GENERAL NOTES:**
- ALL GROUNDING ELECTRODES AS DESCRIBED IN THE NATIONAL ELECTRICAL CODE, 2014 EDITION, SECTIONS 250.52(A)(1) THROUGH (A)(6), THAT ARE PRESENT AT EACH BUILDING OR STRUCTURE SERVED SHALL BE BONDED TOGETHER TO FORM THE GROUNDING ELECTRODE SYSTEM. GROUNDING ELECTRODES AS DESCRIBED IN THE NATIONAL ELECTRICAL CODE, 2014 EDITION, SECTIONS 250.52 (A)(1), (A)(2), (A)(3), AND (A)(7), SHALL BE SUPPLEMENTED WITH A ROD ELECTRODE AS DESCRIBED IN SECTION 250.52 (A)(5)(d), WHERE NO OTHER GROUNDING ELECTRODE IS PRESENT A ROD ELECTRODE SHALL BE PERMITTED TO BE THE SOLE GROUNDING ELECTRODE.
- EXCEPTION: CONCRETE-ENCASED ELECTRODES OF EXISTING BUILDINGS OR STRUCTURES SHALL NOT BE REQUIRED TO BE PART OF THE GROUNDING ELECTRODE SYSTEM WHERE THE STEEL REINFORCED BARS OR RODS ARE NOT ACCESSIBLE FOR USE WITHOUT DISTURBING THE CONCRETE.

08 GROUNDING ELECTRODE SYSTEM DETAIL
NOT TO SCALE

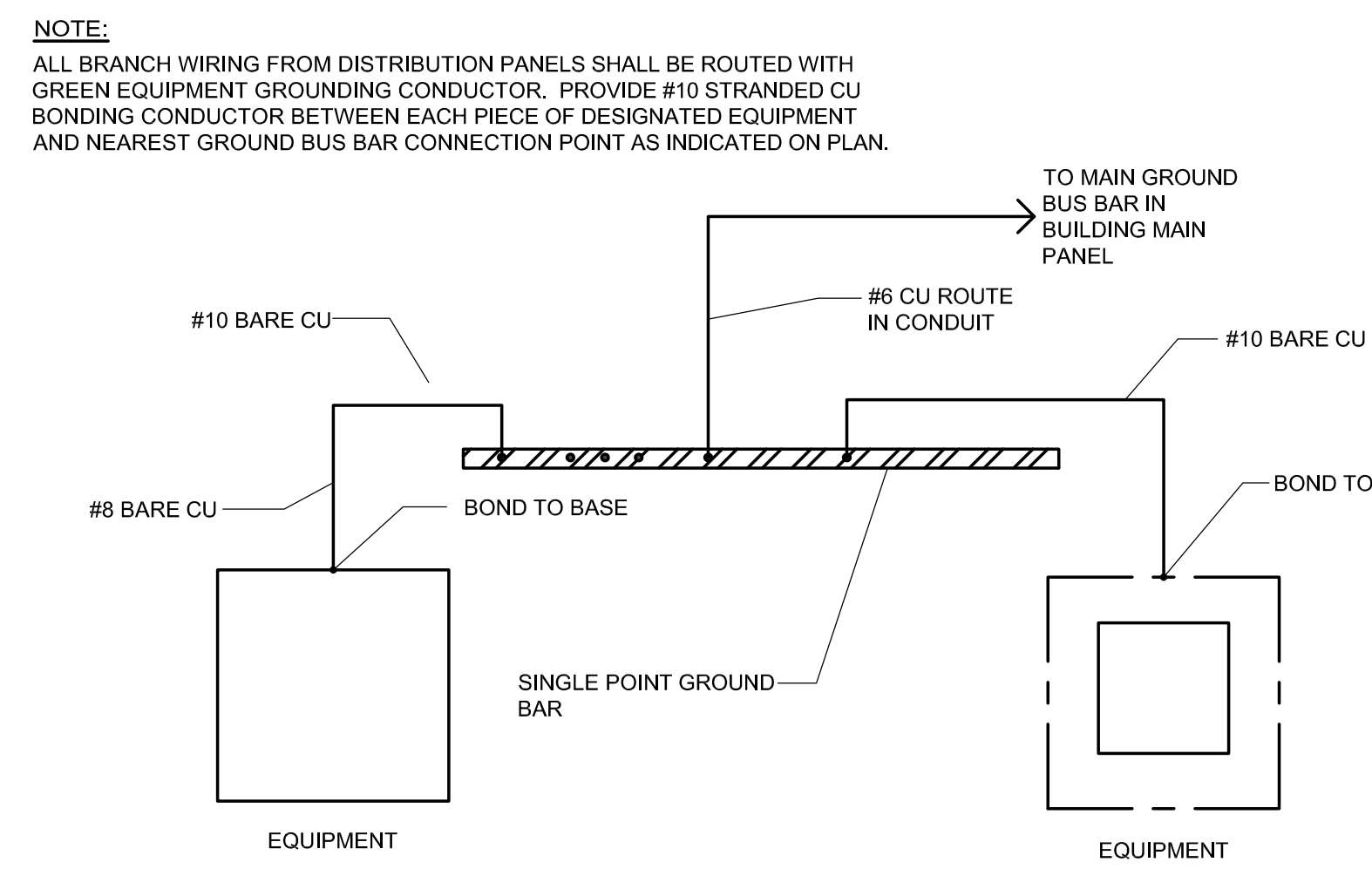

06 SINGLE POINT GROUNDING DIAGRAM
NOT TO SCALE

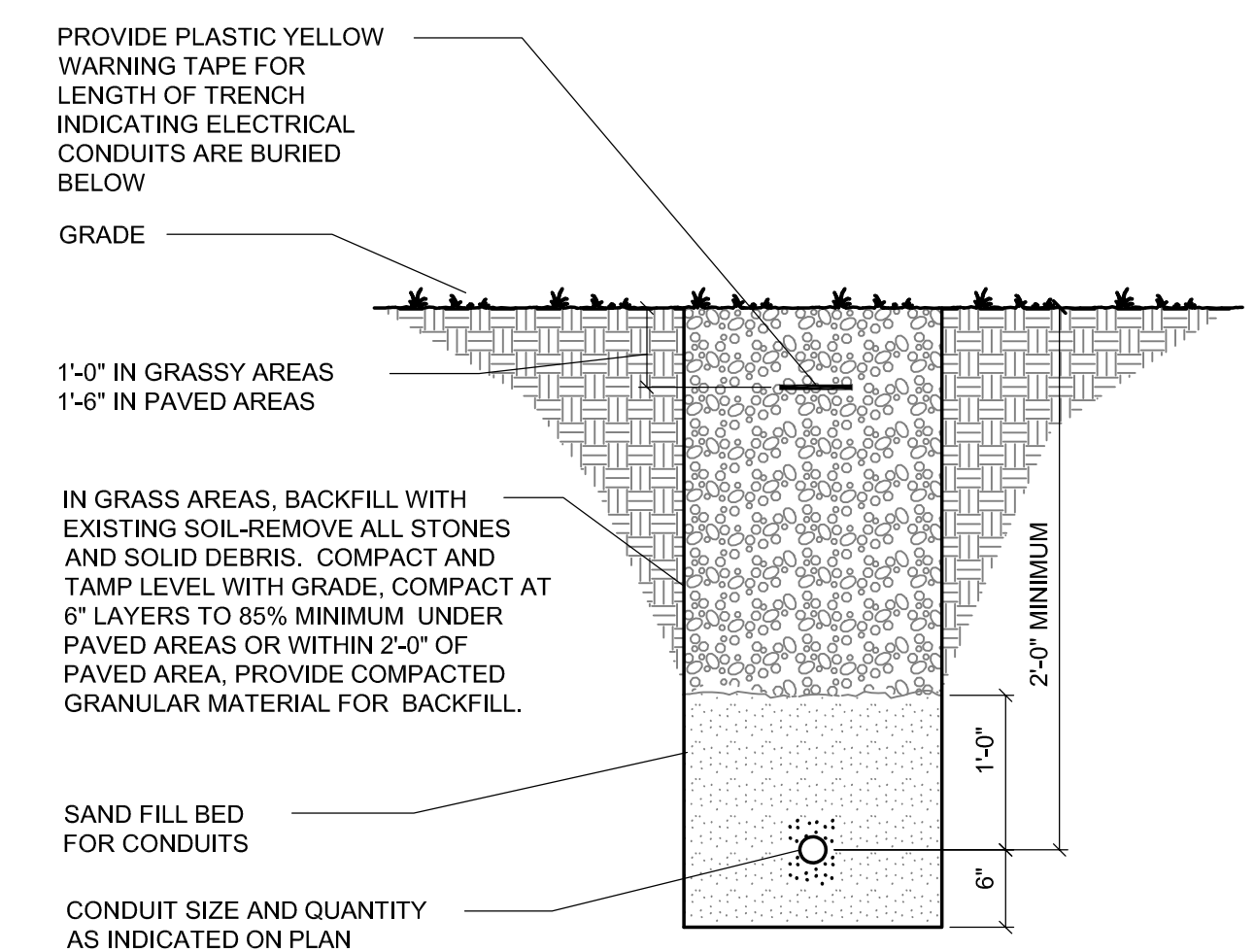

07 CONDUIT TRENCH DETAIL
NOT TO SCALE

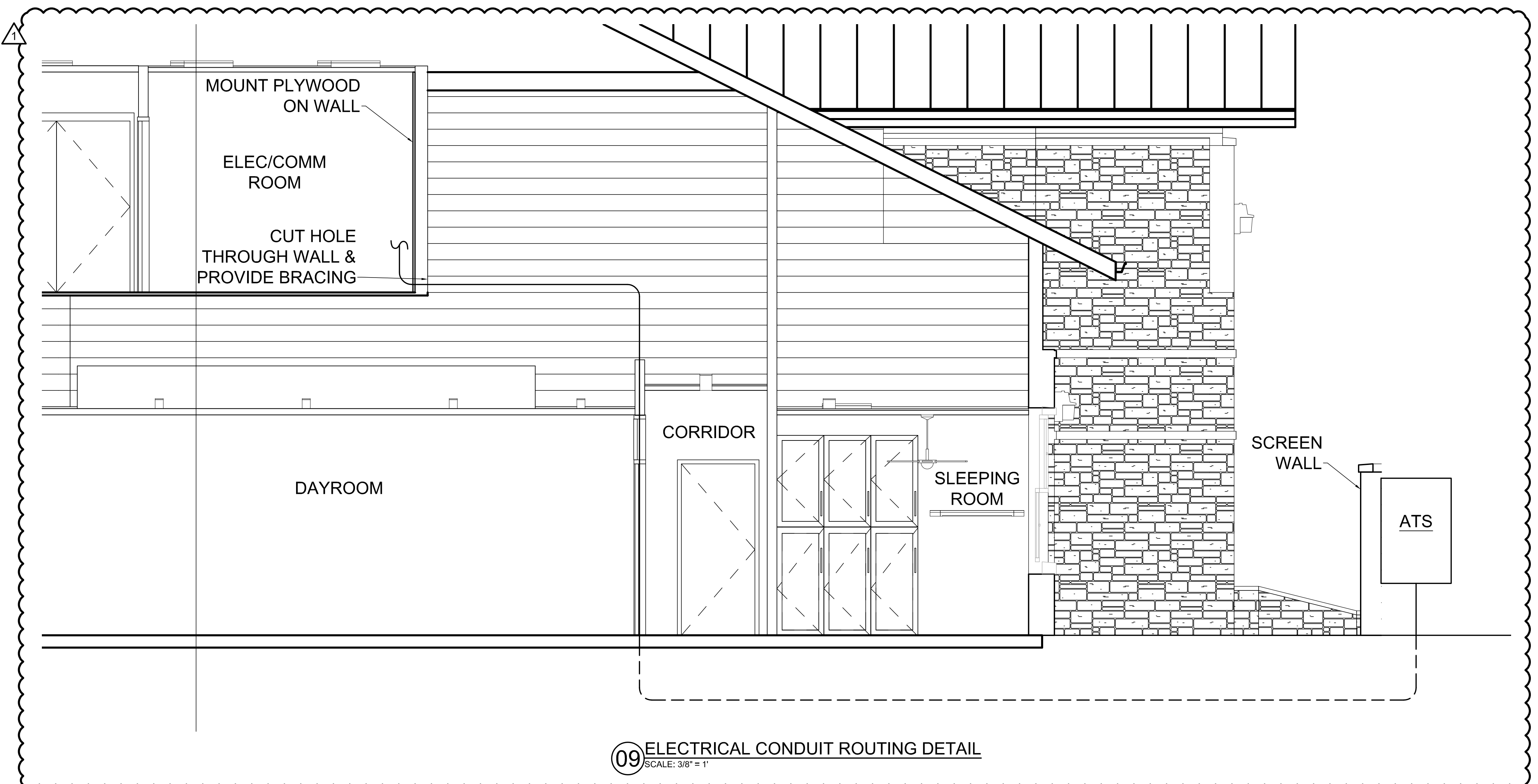

09 ELECTRICAL CONDUIT ROUTING DETAIL
SCALE: 3/8" = 1'

NO.	REVISION	DATE
1	ISSUE FOR PERMIT	11/16/18
2	ADDENDUM 1	11/29/18

